

# Agricultural Series Hydraulic Cylinders

## Installation Guide

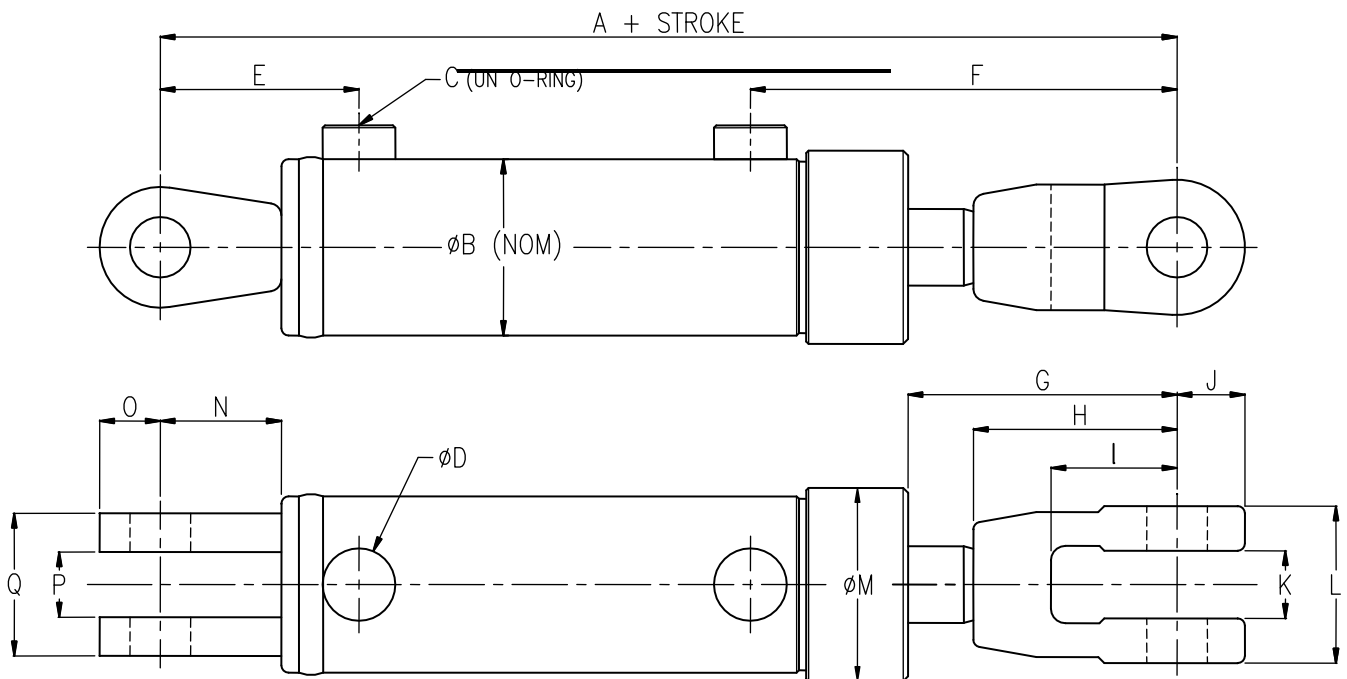

BORE	ROD DIA.	A	B	C	D	E	F	G	H	I	J	K	L	M	N	O	P	Q
2"	1 ¼"	311	61	9/16"	22	76	202	153	75	50	27	27	51	68	50	25	27	51
2 ½"	1 ½"	311	73	¾"	30	82	174	109	82	52	28	27	65	80	50	26	27	59
3"	1 ½"	311	87	¾"	30	84	169	104	82	52	28	27	65	94	50	26	27	59
3 ½"	1 ¾"	311	100	¾"	30	84	169	104	82	52	28	27	65	111	50	26	27	59
4"	1 ¾"	311	114	¾"	30	88	158	93	82	52	28	27	65	N/A	50	32	27	59
5"	2"	311	143	¾"	30	88	163	91	85	55	32	28	78	N/A	50	32	27	78

2", 2 ½", 3" & 3 ½" bore cylinders have external gland nuts.

4" & 5" bore cylinders have internal threaded glands.

5" bore cylinders above 18" stroke have a 2 ½" diameter piston rod.

All cylinders are supplied with 1" dia. Clevis pins & R-Clips.

Non-standard bore sizes and stroke lengths can be manufactured on request.

Please contact our Sales Department for a quote.